



Chiba Japan
Convenient Conventions

UNIQUE VENUES

UNIQUE VENUES

Chiba-Exclusive Facilities

Location Map



Table of Contents

- 1 Mihama-en Japanese Garden p.3**
- 2 BOTANICA MUSEUM p.7**
- 3 Chiba JPF Dome p.9**
- 4 Chiba City Museum of Art p.11**
- 5 Chiba City Folk Museum (Chiba Castle) p.13**
- 6 Chibaminato Harbour Area p.15**
- 7 Open-Air Museum Bōsō-no-Mura p.17**
- 8 Naritasan Museum of Calligraphy p.19**
- 9 Museum of Aeronautical Sciences p.21**
- 10 NIPPONIA KAGURA p.23**
- 11 Porsche Experience Center Tokyo p.25**





Mihama-en 見浜園
16,000 m²

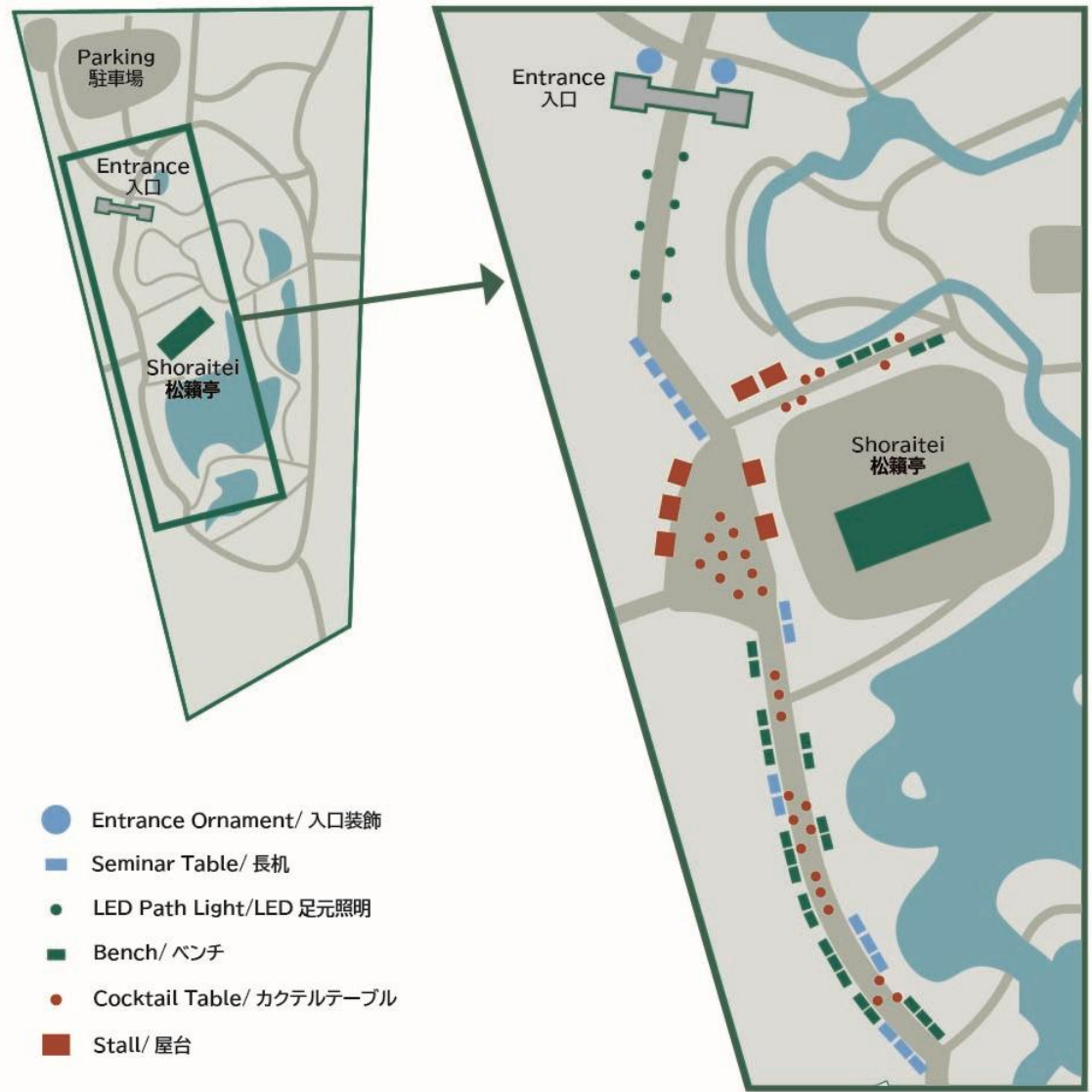

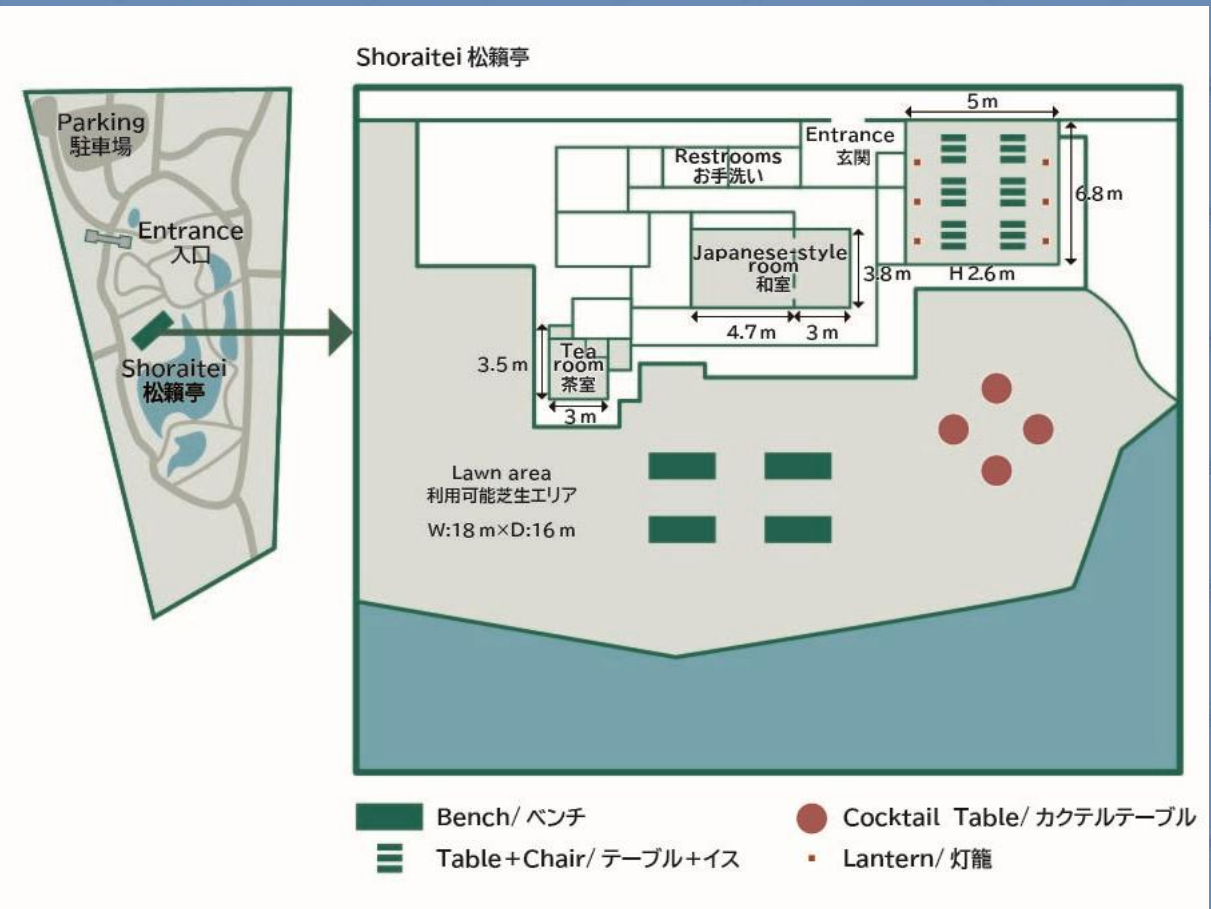

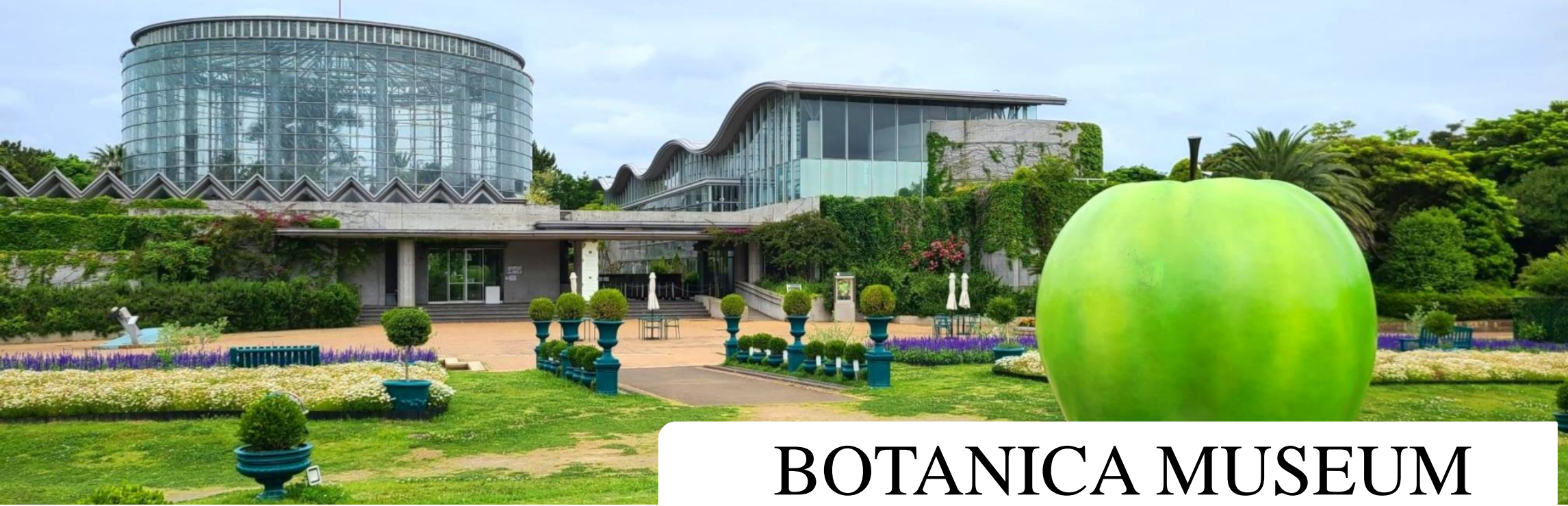

BOTANICA MUSEUM

Experience the Miracle of Nature

Founded in 1995 and newly reopened in 2025, the BOTANICA MUSEUM is home to over 48,000 plants and 1,600 species. The museum is divided into five main areas: Atrium, Greenhouse, Garden, Workshop and Restaurant. The museum is designed to engage all five senses to fully experience the appeal of nature:

Sight: Objects sprouting from the seeds of sensibility transform sight into emotion.

Hearing: The sounds of nature resonate throughout the museum, transforming hearing into mind and body.

Smell: Objects that emphasize scent evoke "memories," transforming smell into memory.

Touch: Touching plants, miracles of nature, transforms touch into essence.

Taste: A restaurant integrated with nature transforms taste into abundance.

The museum was produced by Hikaru Seino, a leading floral artist active around the world. He also founded GANON FLORIST in 2013 and has been invited to give lectures as a maestro at fashion shows overseas and at a Gaudi architecture exhibition in Spain.

The restaurant offers dishes using edible flowers, allowing guests to enjoy seasonal plants in the courtyard, making the museum an ideal location for special occasions, such as parties.

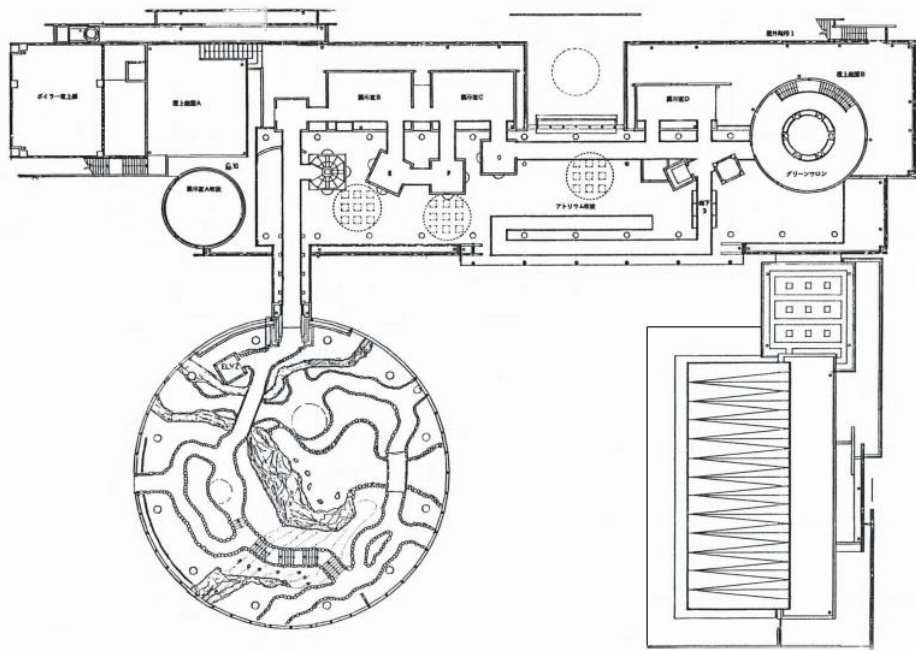
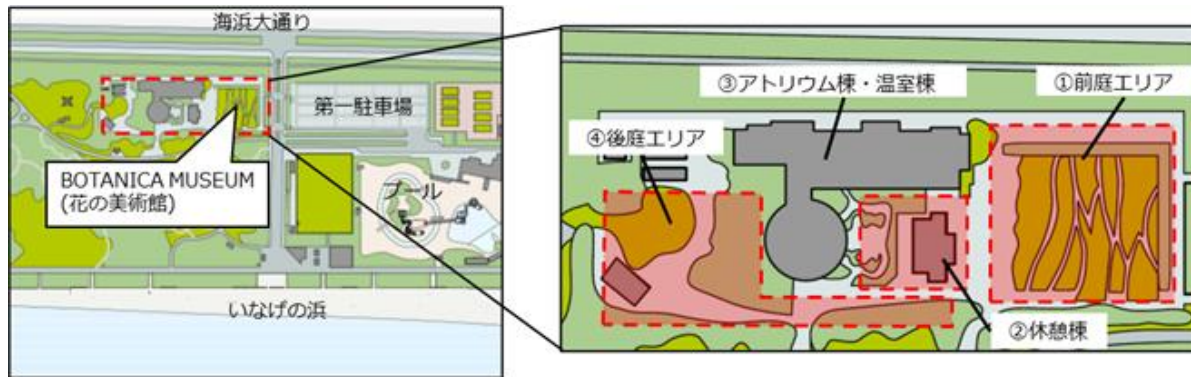

Address	7-2-4 Takahama, Mihama Ward, Chiba City, Chiba Prefecture
Access	40 minutes by car from Narita Airport 45 minutes by car from Haneda Airport 40 minutes by car from Tokyo Station
Website	https://sunsetbeachpark.jp/botanicamuseum/
Hours	Tuesday–Thursday 10:00–16:00 Fri, Sat, Sun & Holidays 10:00–16:00 and 17:00–21:00 Closed: Mondays (if Monday falls on a holiday, closed on the following day) <i>*Please enquire with the museum’s management and the restaurant regarding renting the facility for events.</i>
Facility Outline	Atrium Building Greenhouse Outdoor Garden Restaurant 11 tables with seating for 4, plus 6 terrace tables with seating for 4.
Notes	• Please consult on holding parties and events in both the terrace and restaurant, or the entire museum.
Past Events	-



CHIBA JPF DOME

CHIBA JPF DOME was completed in October 2021 at the site of the Chiba Bicycle Racetrack is a world-class velodrome with a 250-meter wooden bank.

Facilities include arena seats, VIP rooms, a bar, and three food areas. This venue allows unique stage settings that utilize cutting-edge audio and lighting equipment, next-generation visual equipment and laser lighting, making it suitable not only for bicycle races but also for other sporting events, music events and MICE events.



Address	4-1-1 Benten, Chuo Ward, Chiba City, Chiba Prefecture
Access	10-minute walk from JR Chiba Station 35 minutes by car from Narita Airport 50 minutes by car from Haneda Airport 60 minutes by car from Tokyo Station
Website	https://chiba-jpf-dome.com/
Hours	08:30-19:00 Rental Hours are 08:00-22:00 Closed: Year-end, New Year's holidays and occasional closures *Please ask for details about private events
Facility Outline	Height: 27.2m (includes an underground floor) Ceiling: Ring Shell (single-layer string dome) Building area: about 9,600 m ² Total Area: about 14,300 m ² Arena: 2,500 m ² Total Capacity: 3,000 people Number of Seats: 2,000 3 VIP rooms
Others	<ul style="list-style-type: none"> ▪ Equipped with a large video screen, stage lighting, and sound system. ▪ No designated catering vendor (consultation required)/ ▪ Applications are generally accepted starting on the 1st day of the month one year prior to the event date.
Past Events	2022: E-sports game 「VALORANT」 Champions Tour 2025: Running event 「Full house」

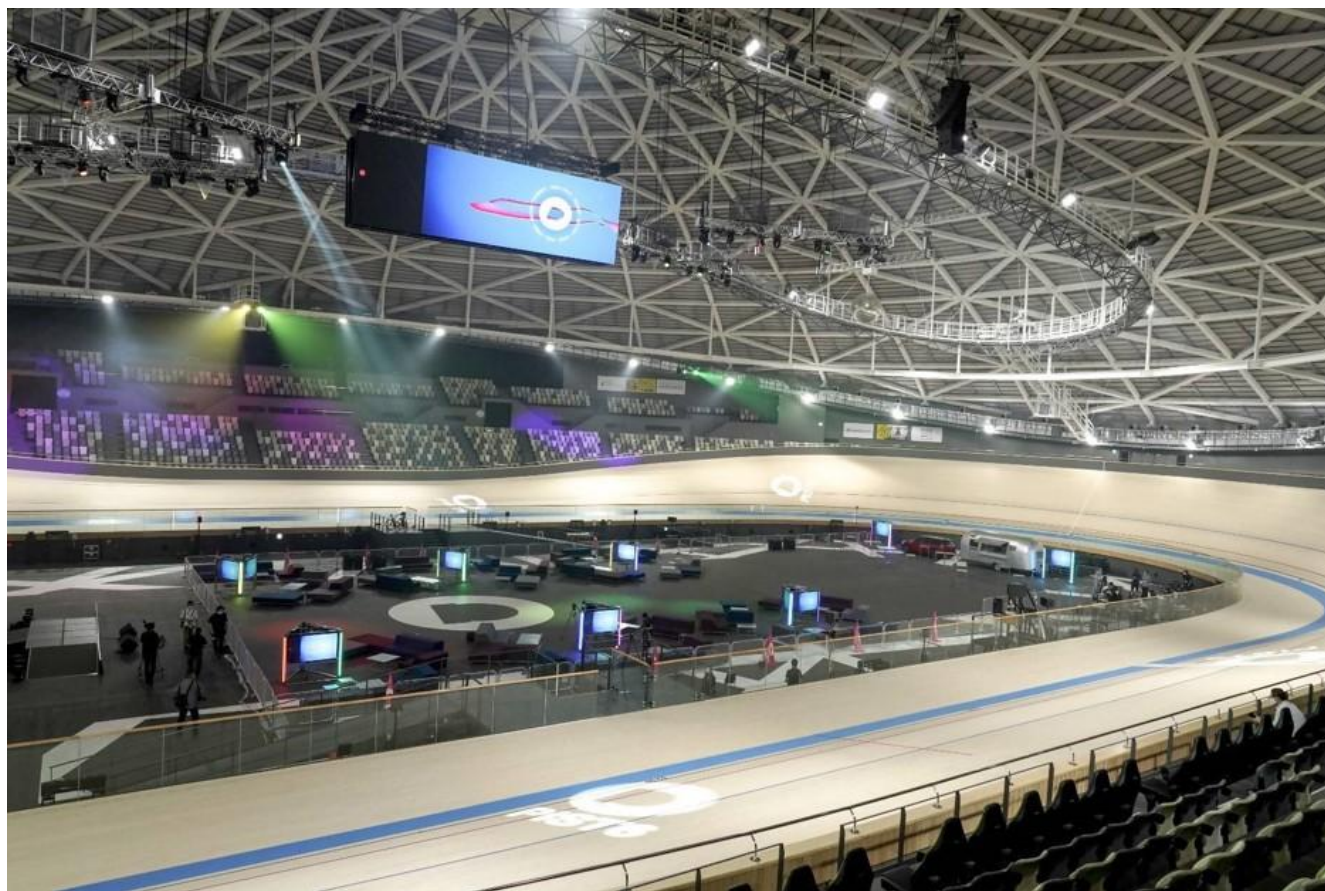

Chiba City Museum of Art

The interior of this unique museum preserves the original neo-Renaissance-style when it was first built as a bank before World War II.

Following expansion work, the museum reopened on July 11th 2020 with additional facilities to attract a broader range of age groups, as well as existing galleries used for planned exhibitions.

Guests can enjoy a permanent exhibition that showcases highlights of a collection of around 10,000 artworks, including Ukiyo-e, modern and contemporary Japanese paintings, prints, contemporary art and pieces related to the Bōsō region, as well as interactive projects where visitors can participate alongside artists.

There are also workshop rooms and a glass-walled auditorium, which can be used for a variety of purposes.



Lecture Hall

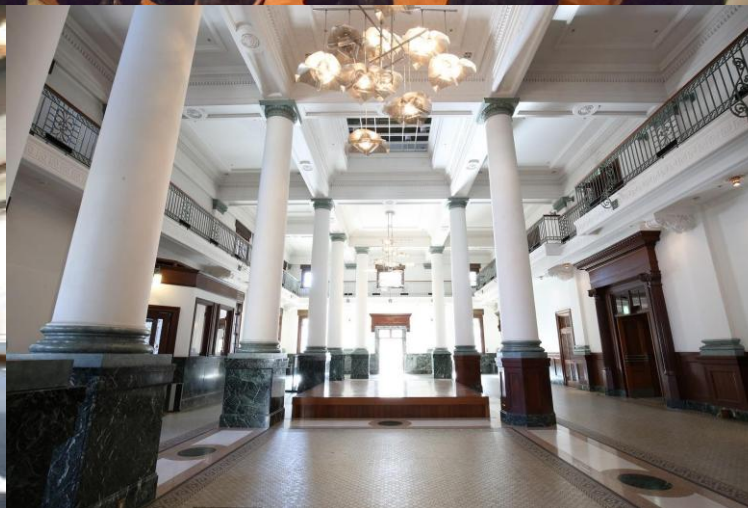

Saya-do Hall

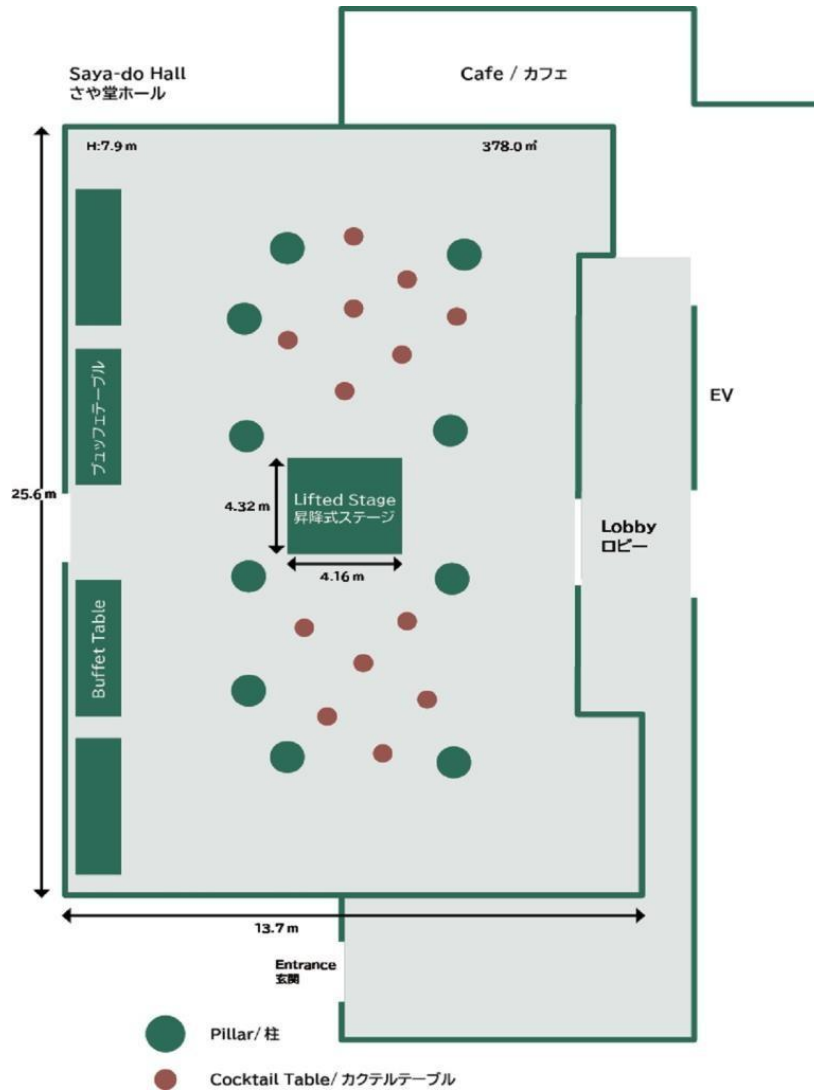

Address	3-10-8 Chuo, Chuo Ward, Chiba City, Chiba Prefecture
Access	40 minutes by car from Narita Airport 50 minutes by car from Haneda Airport 50 minutes by car from Tokyo Station
Website	https://www.ccma-net.jp/
Hours	10:00-18:00 (20:00 on Fridays and Saturdays/the museum closes at 18:00 on some Saturdays when the special exhibition is also closed) Closed: 1 st and 3 rd Mondays of the month, year-end and New Year holidays (Dec 29 th to Jan 3 rd) <i>*Usual rental hours are from 10:00-21:00. Please enquire for more information about renting the facility outside of these times.</i>
Facility outline	Site area: 2,572.4 m ² ; building area: 1859.7 m ² 1st floor: Saya-do Hall 378.0m ² (approx. 200 pax standing) 4th floor: Citizen's Atelier 177.55m ² 5th floor: Workshop space 211.73m ² 9th floor: Citizen's gallery 460m ² (seating capacity for about 150 people) 11th floor: Lecture Hall 180m ² (seating for 180 people) <i>*The 5th and 8th floors are part of the art gallery and there are restaurants on the 1st and 11th floors.</i>
Remarks	<ul style="list-style-type: none"> It is permitted to bring supplies/furniture for events if the museum does not have them. No designated catering vendor (consultation required).
Past events	2014: 99 th Kiwanis International Convention Used for VIP reception including cocktail party and museum tour



Chiba City Folk Museum (Chiba Castle)

The Chiba City Folk Museum (Chiba Castle) was built by the Chiba Clan during the Warring States Period on the site of Inohana Castle. It is now known as “Chiba Castle” by citizens.

Views of downtown Chiba City and the port area can be enjoyed from the observation area on the 5th floor and visitors can learn about the history of Chiba City on the other floors.

The castle is located in Inohana Park, which is famous for cherry blossoms and also has a traditional Japanese tearoom. Every spring, an annual cherry blossom festival takes place in the park.

Why not stop by and enjoy the cherry blossoms while learning about the history of the Chiba Clan?

Address	1-6-1 Inohana, Chuo Ward, Chiba City, Chiba Prefecture
Access	40 minutes by car from Narita Airport 60 minutes by car from Haneda Airport 40 minutes by car from Tokyo Station
Website	https://www.city.chiba.jp/kyodo/
Hours	Museum: 9:00-17:00 (consultation required for use at night and on holidays) Closed Mondays and year-end and New Year holidays (Dec 29 th to Jan 3 rd)
Facility Outline	Park 10,293m ²
Notes	• Please be mindful of noise in the park area after dark (finish by around 21:00).
Past Events	Chiba Castle Cherry Blossom Festival

Inohana Park 亥鼻公園
10,293 m²

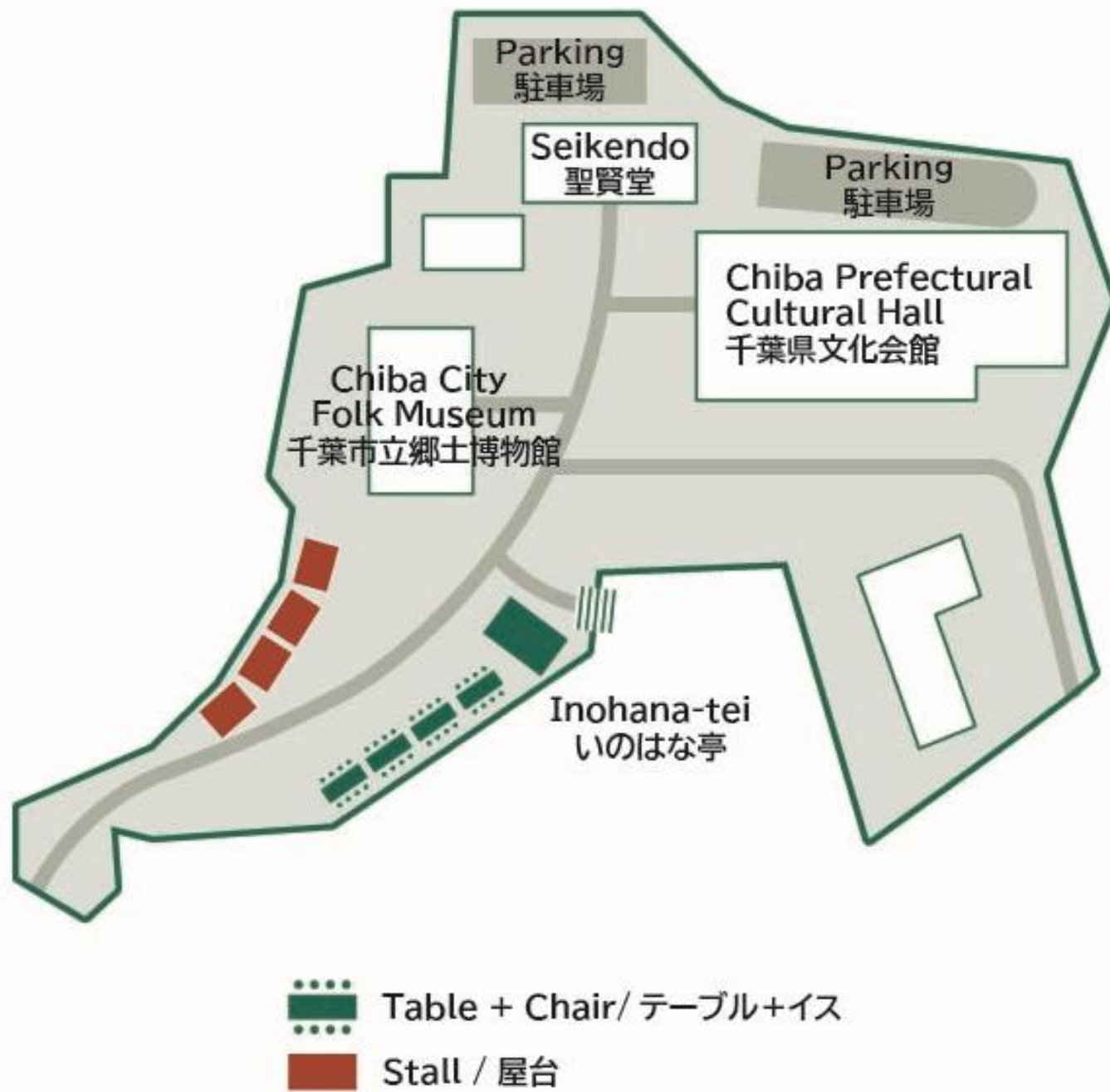

Chibaminato Harbour Area

Chibaminato port and pier (Chiba Central Port's passenger ship pier) has been developed together with the K's Harbor (a ferry passenger terminal) commercial facility as part of Chiba Port Park, where visitors can enjoy a natural environment beside the sea.

Guests can use three facilities (PIER-01, Ocean Table and Amandan Sail) near the port and the green space in front of the pier in an integrated manner to hold various types of large-scale outdoor events and parties.





Amandan Sail

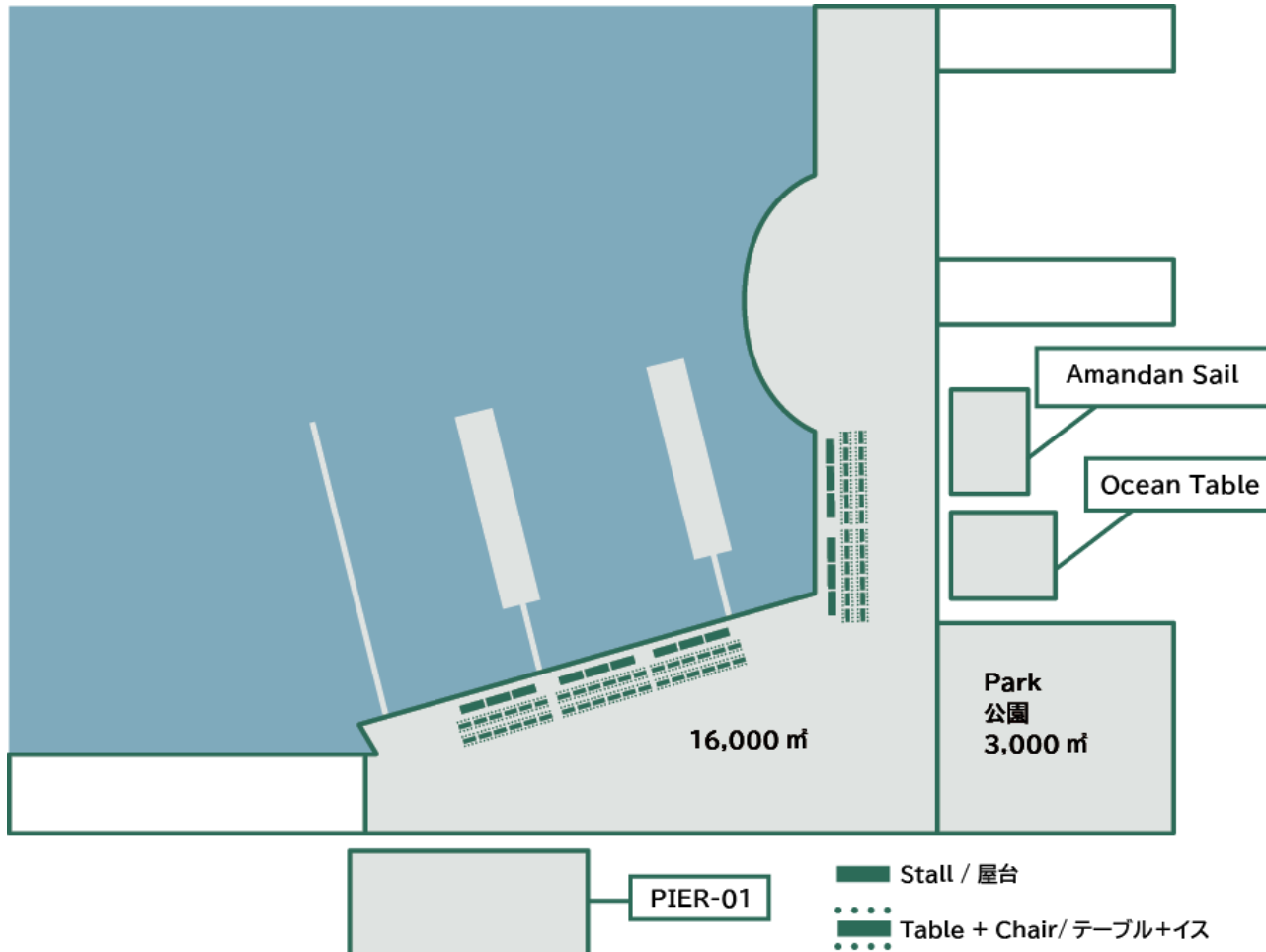

Address	Chuoko, Chuo Ward, Chiba City, Chiba Prefecture
Access	50 minutes by car from Narita Airport 70 minutes by car from Haneda Airport 40 minutes by car from Tokyo Station
Website	https://www.chiba-port.com/voice.html
Hours	PIER-01 11:00-23:00 Amandan Sail 11:00-19:00 ※Lunch 11:30-15:30 (L.O.14:30) Ocean table 10:00-24:00 The port and deck area are always open. Consultation is required for events.
Facility outline	Around Chiba Central Port (incl. park) 19,000m ² Facilities: PIER-01 350m ² (300 standing) Amandan Sail 1 st floor: Lounge 105m ² 2 nd floor: The Seas 220m ² Breeze Bay 186m ² Ocean table 1 st floor: Restaurant 100 standing Terrace 80 standing 2 nd floor: Party room 80 standing Terrace 20 standing
Notes	<ul style="list-style-type: none"> • Applications for park use must be submitted to Chiba City. • Individual facilities may also be used separately. • Mermaid shows available in the giant aquarium at PIER-01.
Past Events	A local annual festival called “Sanbashi Matsuri”



Open-Air Museum Bōsō-no-Mura

This history museum aims to allow visitors to experience traditional lifestyles and crafts native to the Bōsō region and learn about history through the exhibition of archaeological antiquities from across the prefecture in recreated houses of samurai, merchants, farmers, as well as through interactive workshops and experiences.

Visit Bōsō-no-Mura to deepen your understanding of traditional culture using all five senses. A unique venue, visitors can step into the past and enjoy the village streets and a traditional town square of Bōsō in a rich natural environment near Narita Airport.



Event Square

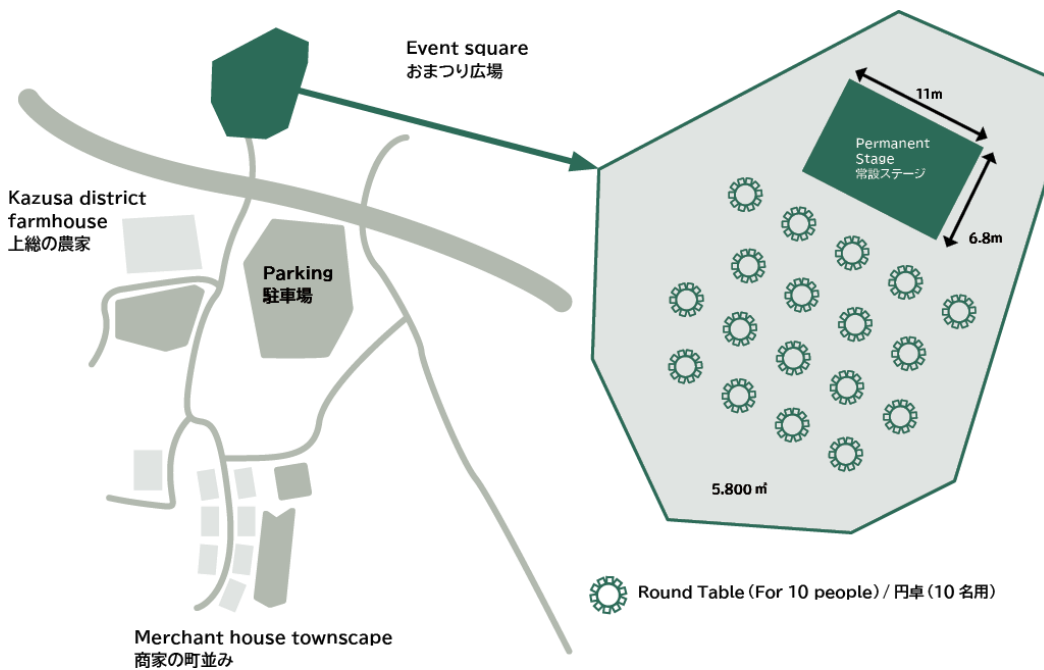

Former main hall of Gakushuin Primary School
(Important Cultural Property)



Kazusa district farmhouse

Address	1028 Ryukakuji, Sakae-machi, Inba-gun, Chiba Prefecture
Access	20 minutes by car from Narita Airport 80 minutes by car from Haneda Airport 80 minutes by car from Tokyo Station
Website	https://www.chiba-muse.or.jp/MURA/
Hours	9:00–16:30 Closed: Mondays and year-end and New Year holidays (If Monday falls on a holiday, closed on the following day.) <i>*Please enquire about renting the facility for an event.</i>
Facility Outline	Site area: about 51 ha (504,923 m ²) Building: 78 buildings (1 Fudoki-no-Oka Museum building, 3 cultural asset buildings, 24 reproduced buildings and 50 other buildings), total of about 8,862.68 m ² Merchant house townscape 1,150m ² Event Square 5,800m ² Former main hall of Gakushuin Primary School 655m ²
Notes	<ul style="list-style-type: none"> • The use of open flame may be possible upon prior consultation. • Partial lighting is available at night. • Wheelchairs and strollers available for rent. • Seven accessible restrooms located throughout the facility. • Available to wear Kimono or Ninja clothes at the Cosplay Annex (additional charge). Experiences: <ul style="list-style-type: none"> • Making rice crackers, brown rice tea, thick sushi rolls, soba noodles, hard candy, papier-mâché, Japanese candles, bamboo crafts and sandals
Past Events	1992: AIPPI (International Association for the Protection of Intellectual Property) 35th Tokyo Conference spouse program



Naritasan Museum of Calligraphy

The Naritasan Museum of Calligraphy is a comprehensive museum dedicated to calligraphy that holds around seven rotating exhibitions each year. Opened in 1992, the museum's collection of 6,000 items ranges from delicate old writings and early sutra copies dating back to the Heian and Nara Periods, to large and dynamic contemporary calligraphic works. The museum plans exhibitions on a wide range of different themes to share the appeal of calligraphy. Visitors to the museum can expect to find something new every time they go.

Naritasan Park is located directly behind the museum, spanning an impressive 160,000 square metres. Within the park, visitors can enjoy the seasonal scenery, including stone monuments to famous Japanese literary figures, as well as plum blossoms, cherry blossoms, wisteria, chrysanthemums and autumn leaves. The floating temple (Ukimido), the suikinkutsu (water harp cave) and the "Fudedama" (brush spirit) monument are also popular attractions.

With its massive exterior and spacious, high-ceilinged interior, the museum was built to a temple-inspired design. Upon entering the museum building, your eyes are immediately caught by a 13-meter-high ink impression called "Rubbing of the Stone Stele's Inscription of Taishan", which is exhibited in the 20-metre high Central Hall. The scale of the work, which was reportedly written by Emperor Xuanzong of the Tang Dynasty, is something to experience.

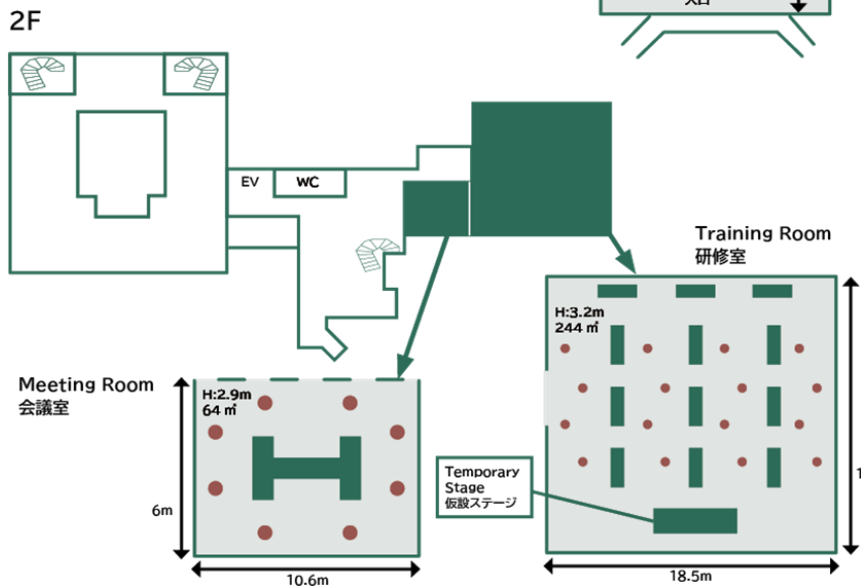
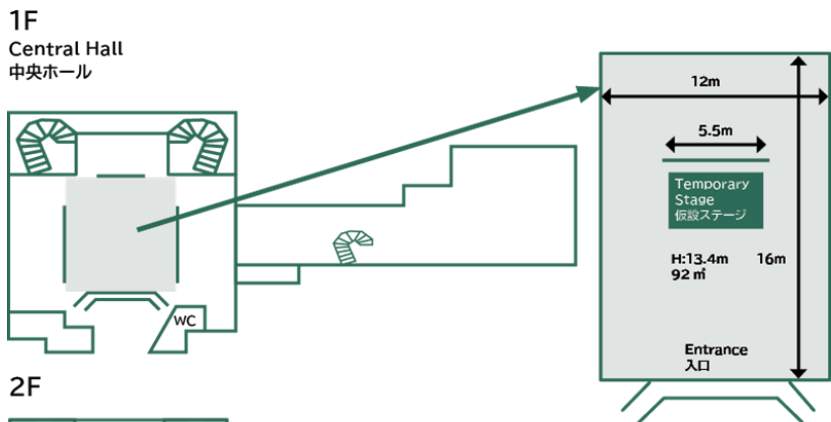

Address	640 Narita, Narita City, Chiba Chiba Prefecture
Access	10 minutes by car from Narita Airport 70 minutes by car from Haneda Airport 70 minutes by car from Tokyo Station
Website	https://www.naritashodo.jp/
Hours	9:00–16:00 (entry possible until 15:30) Closed Mondays (if Monday falls on a holiday, closed on the following day), New Years and other irregular closing days <i>*Please enquire for more information about renting the facility.</i>
Facility Outline	Total floor area: 3,838 m ² 1st floor: Central Hall 350m ² (about 300 people) 2nd floor: Training Room 244m ² (approx. 200 pax standing) and Conference Room 64m ² Sekishoan tearoom (separate building)
Notes	<ul style="list-style-type: none"> • Commercial use is prohibited. • No designated catering vendor (consultation required). • Open flames are not allowed. • Use of food areas may be restricted depending on the situation.
Past Events	2017: 10th Asia Pacific Conference on Speech, Language and Hearing Welcoming at the Central Hall and Banquet party in the Training Room 2021: MICE Hospitality Lecture Live calligraphy performance and experience after the lecture

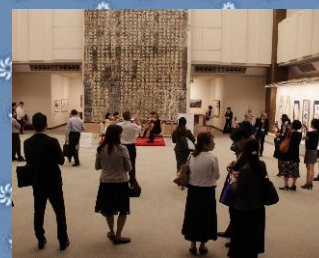



Museum of Aeronautical Sciences

Japan's first museum dedicated to civil aviation exhibits real aircraft and engines. Visitors can also enjoy a flight simulator experience. From the observation room on the fifth floor, you can get a close-up view of planes taking off and landing at the adjacent Narita International Airport.



Address	111-3 Iwayama, Shibayama-machi, Sanbu-gun, Chiba Prefecture
Access	10 minutes by car from Narita Airport (bus available from Narita Airport and JR/Keisei Narita Stations) 70 minutes by car from Haneda Airport 60 minutes by car from Tokyo Station
Website	https://www.aeromuseum.or.jp/
Hours	10:00-17:00 (last entry at 16:30) Closed: Mondays (if Monday falls on a holiday, closed on the following day) and year end holidays (Dec 29 th to Jan 3 rd) <i>*Please enquire for more information about renting the facility</i>
Facility Outline	Main Building: 5 stories 1 st floor: Multipurpose Hall 95 m ² (30 standing) West Wing Exhibition Room 300 m ² (100 standing) 4 th floor: Restaurant 124 m ² (40 standing) 5 th floor: Observation room 193 m ² (80 standing) Experience Hall: 2 stories 1 st floor: Experience Hall 261 m ² (200 standing)
Notes	<ul style="list-style-type: none"> ▪ Use must not interfere with regular visitor viewing or hands-on activities. ▪ No open flames. ▪ No hazardous materials or liquids permitted. ▪ Food consumption subject to prior consultation. ▪ Elevators available (the observation room on the 3rd floor of the main building can only be accessed by stairs)
Past Events	-



Experience Hall



Outdoor Exhibition Space



Main Building West Wing Exhibition Room
本館西棟展示室

Experience Hall
体験ホール



West Wing Exhibition Room

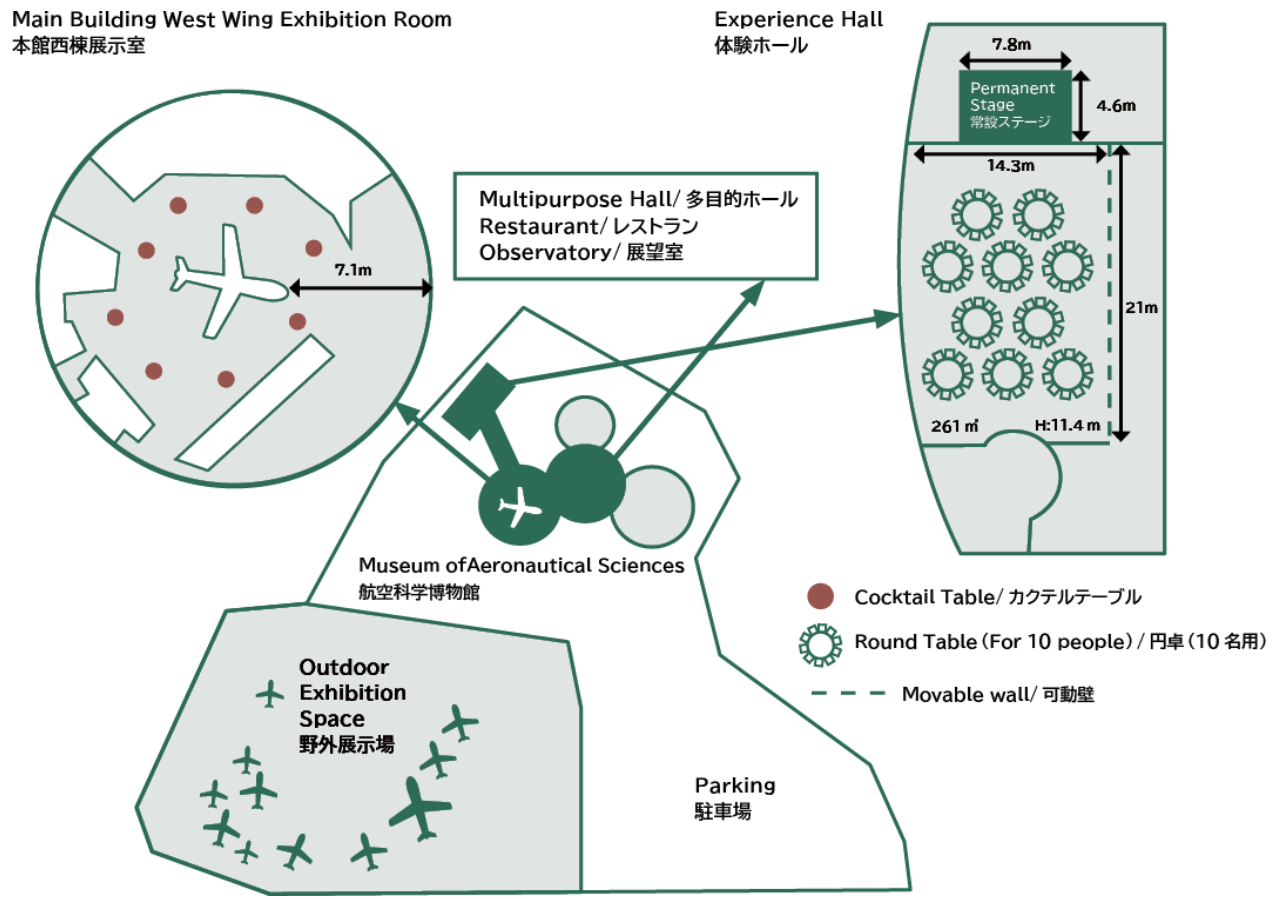



Address	1708-2 Sawara-i, Katori City, Chiba Prefecture
Access	30 minutes by car from Narita Airport 70 minutes by car from Haneda Airport 60 minutes by car from Tokyo Station
Website	https://www.nipponia-sawara.jp/
Hours	Lunch (excluding Tuesdays) 11:30-15:00 (L.O. 14:00) Dinner 17:30-22:00 (L.O. 20:00) <i>*Please enquire for more information about renting the facility</i>
Facility Outline	Banquet area 160m ² (96 seats with the normal layout) Bar corner 28m ² Lounge 97m ²
Notes	• Designated catering vendor.
Past Events	-

NIPPONIA KAGURA



Located near Narita Airport, Sawara is a historic town known for its beautifully preserved old streets and Edo-style traditional merchant houses. The area developed around food and brewing culture, producing sake, miso and soy sauce using high-quality local rice, with a long-standing focus on fermentation and regional ingredients. Guests can enjoy dishes made with locally sourced ingredients unique to this area—featuring fermented foods such as sake lees—paired with sake delivered directly from nearby breweries.

Experience the rich flavors of traditional Japanese seasonings and sake in a banquet space renovated from a former brewery.

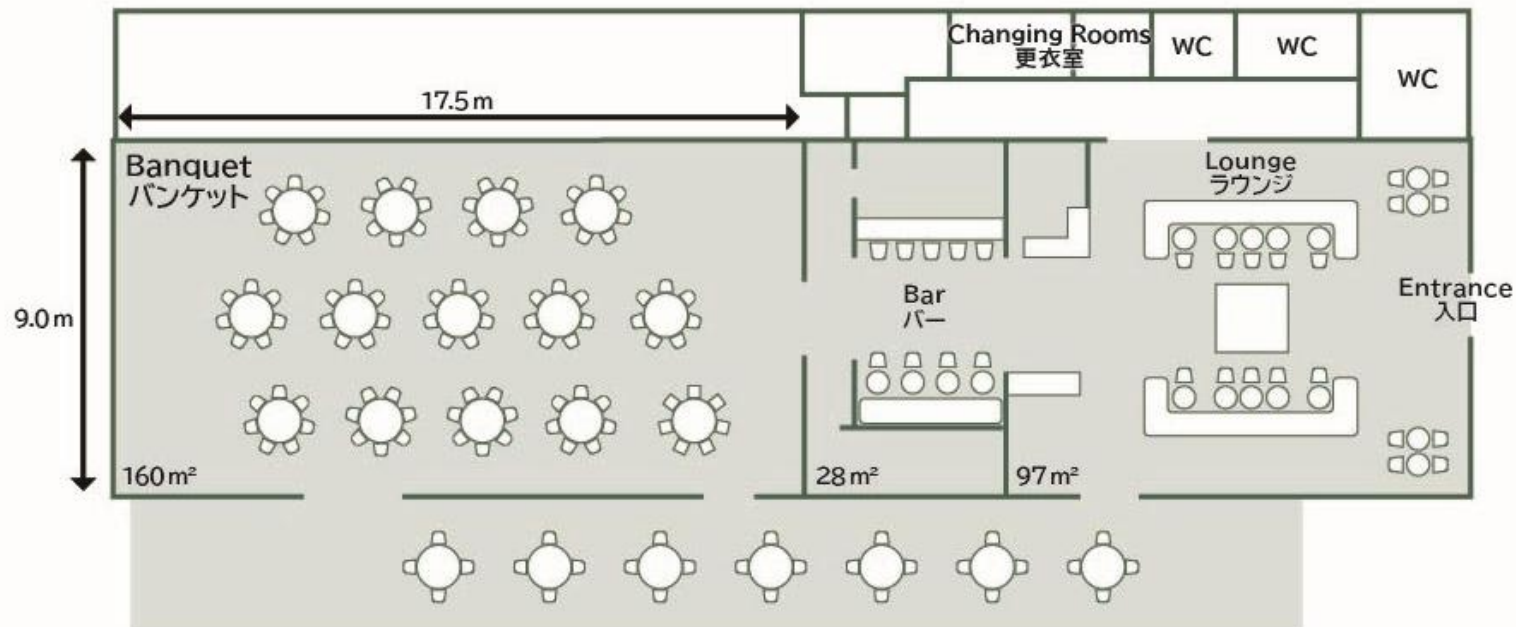

Sawara Merchant Town Hotel NIPPONIA KAGURA Building
 佐原商家町ホテル NIPPONIA KAGURA 棟



 Round Table(For 7 people) / 円卓 (7名用)
  Table(For 4 people) / テーブル (4名用)





Porsche Experience Center Tokyo

As the ninth Porsche Experience Center in the world and the only one in Japan, Porsche Experience Center Tokyo offers an immersive Porsche brand experience while at the center. Located in Kisarazu, the facility features a building inspired by the traditional “Edo Kiriko” hand-cut glass design and a unique 2.1 km handling track that makes use of the natural terrain. A variety of programs engage both the intellect and the five senses. Flexible event spaces are available for a wide range of purposes, including special events, team building for business partners and corporate hospitality. Guests can enjoy exclusive driving programs using state-of-the-art facilities, as well as realistic driving experiences in the Simulator Lab on world-renowned race tracks. Meeting rooms, hands-on driving experiences, and team-building programmes using Porsche vehicles are also available. In addition to the on-site restaurant, the first-floor open space can be reserved for private events.





Address	1148-1 Nakanodai, Izushima, Kisarazu City, Chiba Prefecture
Access	15 minutes by car from JR Kisarazu station 50 minutes by car from Tokyo Station 100 minutes by car from Narita Airport 60 minutes by car from Haneda Airport
Website	https://porsche-experiencecenter-tokyo.jp/
Hours	Porsche Experience Center: 8:30-17:00 (opening hours may vary depending on the time of year) Closed: Mondays and other occasional closures. Restaurant: Opening Hours: 11:00-20:00 (L.O. 19:00) Closed: Sundays and Mondays *Please enquire about renting the entire facility or restaurant.
Facility Outline	Site area: 43 ha Building: 2 aboveground floors Track: 2.1 km 1st floor Atrium 480m ² (300 standing) 2nd floor Restaurant 300m ² (150 standing)
Notes	<ul style="list-style-type: none"> Maximum capacity for exclusive driving programmes subject to consultation. Designated catering vendor.

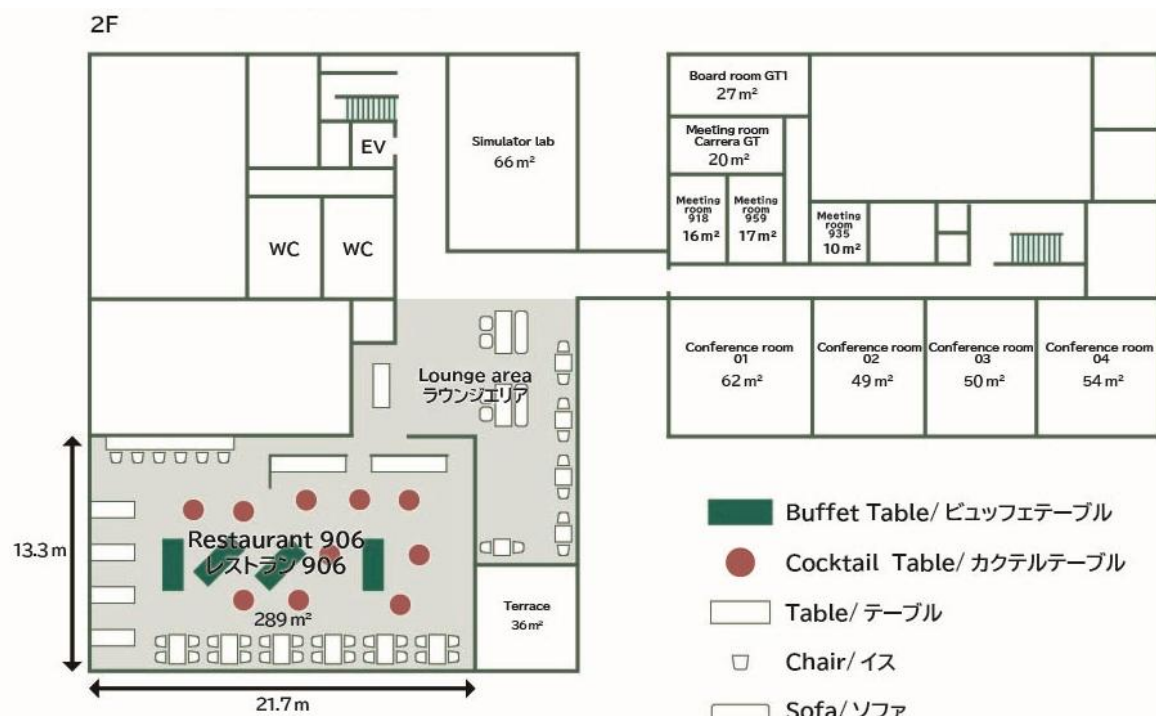
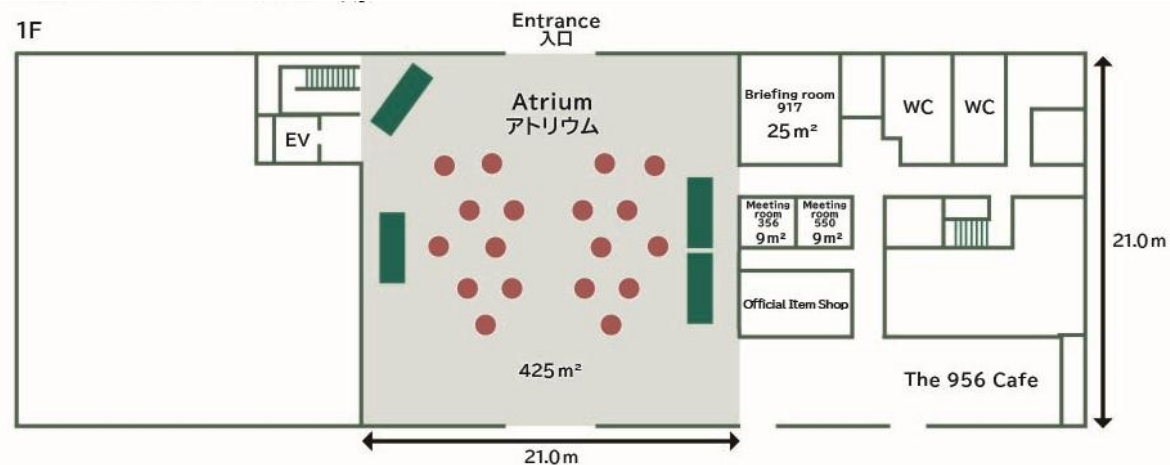

UNIQUE EXPERIENCES
NEW DISCOVERIES



**Chiba Convention Bureau and
International Center (CCB-IC)**

14F Makuhari Techno Garden Building D, 1-3 Nakase,
Mihama Ward, Chiba City, Chiba Prefecture, Japan 261-8501
Phone: 043-297-2751 <https://www.ccb.or.jp/mice/> Email: request@ccb.or.jp